

# DRB12-48PAE-L018 ✓ ACTIVE

DEUTSCH | DEUTSCH DRB

TE Internal #: DRB12-48PAE-L018

Housing for Male Terminals, Wire-to-Wire, 48 Position, .15 in / .185 in / .264 in [6.71 mm / 4.7 mm / 3.81 mm] Centerline, Sealable, DEUTSCH DRB

[View on TE.com >](#)



Connectors > Automotive Connectors > Automotive Housings > DEUTSCH DRB Housings



Connector System: **Wire-to-Wire**

Number of Positions: **48**

Connector & Housing Type: **Housing for Male Terminals**

Centerline (Pitch): **3.81 mm, 4.7 mm, 6.71 mm [ .15 in, .185 in, .264 in ]**

Sealable: **Yes**

[All DEUTSCH DRB Housings \(19\)](#)

## Features

### Product Type Features

Mixed & Hybrid Connector	Yes
Connector Shape	Rectangular
Connector System	Wire-to-Wire
Connector & Housing Type	Housing for Male Terminals
Sealable	Yes
Connector & Contact Terminates To	Wire & Cable
Primary Locking Feature	Integrated in Housing

### Configuration Features

Blank Cavity Position	0
Connector Modification	Wire Router
Connector Seal Code	E Seal
Number of Positions	48
Number of Rows	6

### Electrical Characteristics

Operating Voltage	250 VAC
Nominal Voltage Architecture	12 V, 24 V, 48 V



### Body Features

Cable Exit Angle	180°
Primary Product Color	Black
Connector & Keying Code	A

### Contact Features

Contact Size	Size 12, Size 16, Size 20
Contact Type	Pin
Mating Pin Diameter	1.02 mm, 1.59 mm, 2.39 mm [.04 in][.063 in][.094 in]
Contact Current Rating (Max)	7.5 A, 13 A, 25 A

### Mechanical Attachment

Terminal Position Assurance	Yes
Strain Relief	With
Mating Alignment Type	Keyed
Mating Alignment	With
Connector Mounting Type	Panel Mount

### Housing Features

Housing Material	PA GF
Centerline (Pitch)	3.81 mm, 4.7 mm, 6.71 mm [.15 in][.185 in][.264 in]

### Dimensions

Connector Height	66.19 mm [2.606 in]
Product Width	66.19 mm [2.606 in]
Product Length	52.76 mm [2.077 in]
Row-to-Row Spacing	.64 mm, 7.57 mm, 7.77 mm, 8.2 mm, 8.41 mm [.025 in][.298 in][.306 in][.323 in][.331 in]
Compatible Insulation Diameter Range	1.02 – 2.41 mm, 1.35 – 3.05 mm, 2.46 – 4.01 mm [.04 – .095 in][.053 – .12 in][.097 – .158 in]

### Usage Conditions

Operating Temperature (Max)	125 °C [257 °F]
Operating Temperature Range	-55 – 125 °C [-67 – 257 °F]

### Operation/Application

Circuit Application	Power & Signal
---------------------	----------------



### Industry Standards

Degree of Protection	IP68, IP6K9K
Agency/Standard	SAE J2030

### Packaging Features

Packaging Quantity	36
Packaging Method	Box

### Other

Serviceable	Yes
Connector Position Assurance Capable	No

### Product Compliance

[For compliance documentation, visit the product page on TE.com>](#)

EU RoHS Directive 2011/65/EU	Compliant
EU ELV Directive 2000/53/EC	Compliant
China RoHS 2 Directive MIIT Order No 32, 2016	No Restricted Materials Above Threshold
EU REACH Regulation (EC) No. 1907/2006	Current ECHA Candidate List: JUNE 2023 (235) Candidate List Declared Against: JAN 2023 (233) Does not contain REACH SVHC
Halogen Content	Not Low Halogen - contains Br or Cl > 900 ppm.
Solder Process Capability	Not reviewed for solder process capability

#### Product Compliance Disclaimer

This information is provided based on reasonable inquiry of our suppliers and represents our current actual knowledge based on the information they provided. This information is subject to change. The part numbers that TE has identified as EU RoHS compliant have a maximum concentration of 0.1% by weight in homogenous materials for lead, hexavalent chromium, mercury, PBB, PBDE, DBP, BBP, DEHP, DIBP, and 0.01% for cadmium, or qualify for an exemption to these limits as defined in the Annexes of Directive 2011/65/EU (RoHS2). Finished electrical and electronic equipment products will be CE marked as required by Directive 2011/65/EU. Components may not be CE marked. Additionally, the part numbers that TE has identified as EU ELV compliant have a maximum concentration of 0.1% by weight in homogenous materials for lead, hexavalent chromium, and mercury, and 0.01% for cadmium, or qualify for an exemption to these limits as defined in the Annexes of Directive 2000/53/EC (ELV). Regarding the REACH Regulation, the information TE provides on SVHC in articles for this part number is based on the latest European Chemicals Agency (ECHA) 'Guidance on requirements for substances in articles' posted at this URL: <https://echa.europa.eu/guidance-documents/guidance-on-reach>

### Compatible Parts



TE Part # CAT-D48-SP729  
DEUTSCH Sealing Plugs



TE Part # DRB16-48SAE-L018  
PLG, 48P, BLK, E, CAP, A

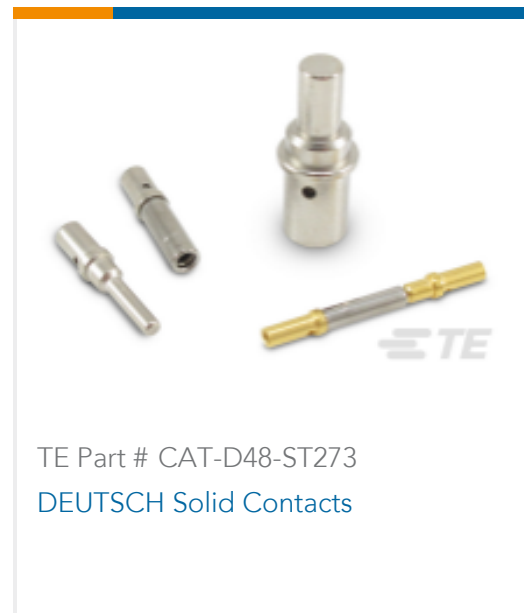

TE Part # CAT-D48-ST273  
DEUTSCH Solid Contacts



TE Part # WB-48PA  
WEDGE LOCK, 48P, REC, GRY, DRB, A



TE Part # CAT-J67-DSCC16  
DEUTSCH Size 16 Crimp Contacts

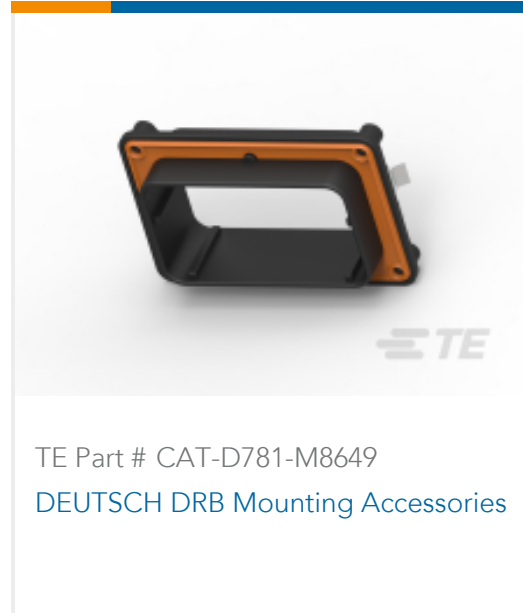

TE Part # CAT-D781-M8649  
DEUTSCH DRB Mounting Accessories



TE Part # DT-RT1  
EXT TOOL, FRONT RELEASE

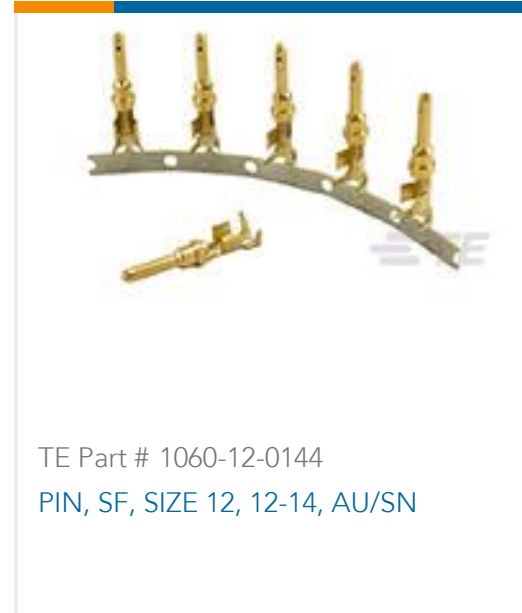

TE Part # 1060-12-0144  
PIN, SF, SIZE 12, 12-14, AU/SN



TE Part # 1060-20-0144  
PIN, SF, SIZE 20, 16-22, AU/SN



TE Part # 1060-20-0244  
PIN, SF, SIZE 20, 16-22, AU/SN



TE Part # 1060-20-0277  
PIN, SF, SIZE 20, 16-22, SN/SN



TE Part # 3315-015-0005  
PROTECT CVR, 48/60P, PLG, YEL, DRB



TE Part # 1060-12-0222  
PIN, SF, SIZE 12, 10, NI/NI



TE Part # 1060-20-0622  
PIN, SF, SIZE 20, 14-16, NI/NI



TE Part # 1060-12-0166  
PIN, SF, SIZE 12, 12-14, NI/SN



TE Part # 1060-20-0222  
PIN, SF, SIZE 20, 16-22, NI/NI



TE Part # 1060-20-0122  
PIN, SF, SIZE 20, 16-22, NI/NI



TE Part # 2300908-1  
0460-003-16329, PIN, SOLID, 20-24AWG, AU



TE Part # 1060-20-0177  
PIN, SF, SIZE 20, 16-22, SN/SN



TE Part # DRB48-60-BT  
BOOT, 48/60P, PLG/REC, ST, BLK

Also in the Series | **DEUTSCH DRB**



Automotive Connector Caps & Covers (1)

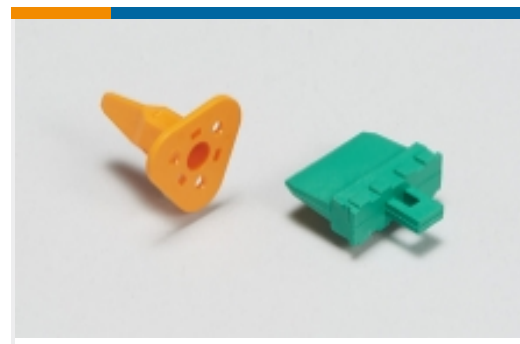

Automotive Connector Locks & Position Assurance(20)

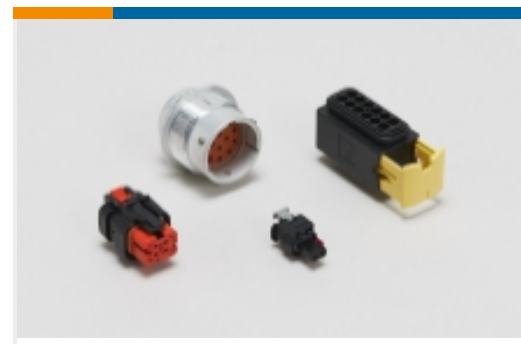

Automotive Housings(19)



Connector Strain Relief(1)



Insertion & Extraction Tools(1)



Other Automotive Connector Accessories(6)

## Customers Also Bought



TE Part #HD34-24-19PE-059  
DEUTSCH HD30 Housings



TE Part #DRB16-60SAE-L018  
DEUTSCH DRB Housings



TE Part #DT04-08PD  
REC, 8P, BRN, N, D

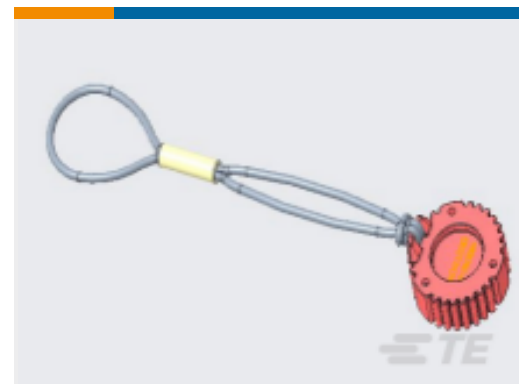

TE Part #HDC9-JDL082397  
DUST CAP, 9P, REC, BLK, LANYARD, HD10

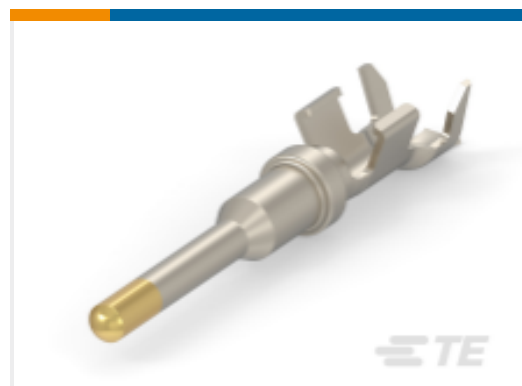

TE Part #1060-16-0144-PS  
PIN, SF, SIZE 16, 14-18, AU/SN, 100 PC



TE Part #2304643-4  
60POS,AMP MCP 2.8,REC HSG ASSY, SLD



TE Part #DRB48-60-BT  
BOOT, 48/60P, PLG/REC, ST, BLK

## Documents

### Product Drawings

REC, 48P, BLK, E, CAP, A

English

### CAD Files

3D PDF

3D

Customer View Model

ENG\_CVM\_CVM\_DRB12-48PAE-L018\_C\_c-drb12-48pae-l018-c.2d\_dxf.zip



English

**Customer View Model**

[ENG\\_CVM\\_CVM\\_DRB12-48PAE-L018\\_C\\_c-drb12-48pae-l018-c.3d\\_igs.zip](#)

English

**Customer View Model**

[ENG\\_CVM\\_CVM\\_DRB12-48PAE-L018\\_C\\_c-drb12-48pae-l018-c.3d\\_stp.zip](#)

English

By downloading the CAD file I accept and agree to the [Terms and Conditions](#) of use.

---

## Datasheets & Catalog Pages

[ICT Terminals and Connectors Catalogue](#)

English

---

## Product Specifications

[Application Specification](#)

English

---

## Agency Approvals

[UL Report](#)

English